

HOUSE FOUNDATION

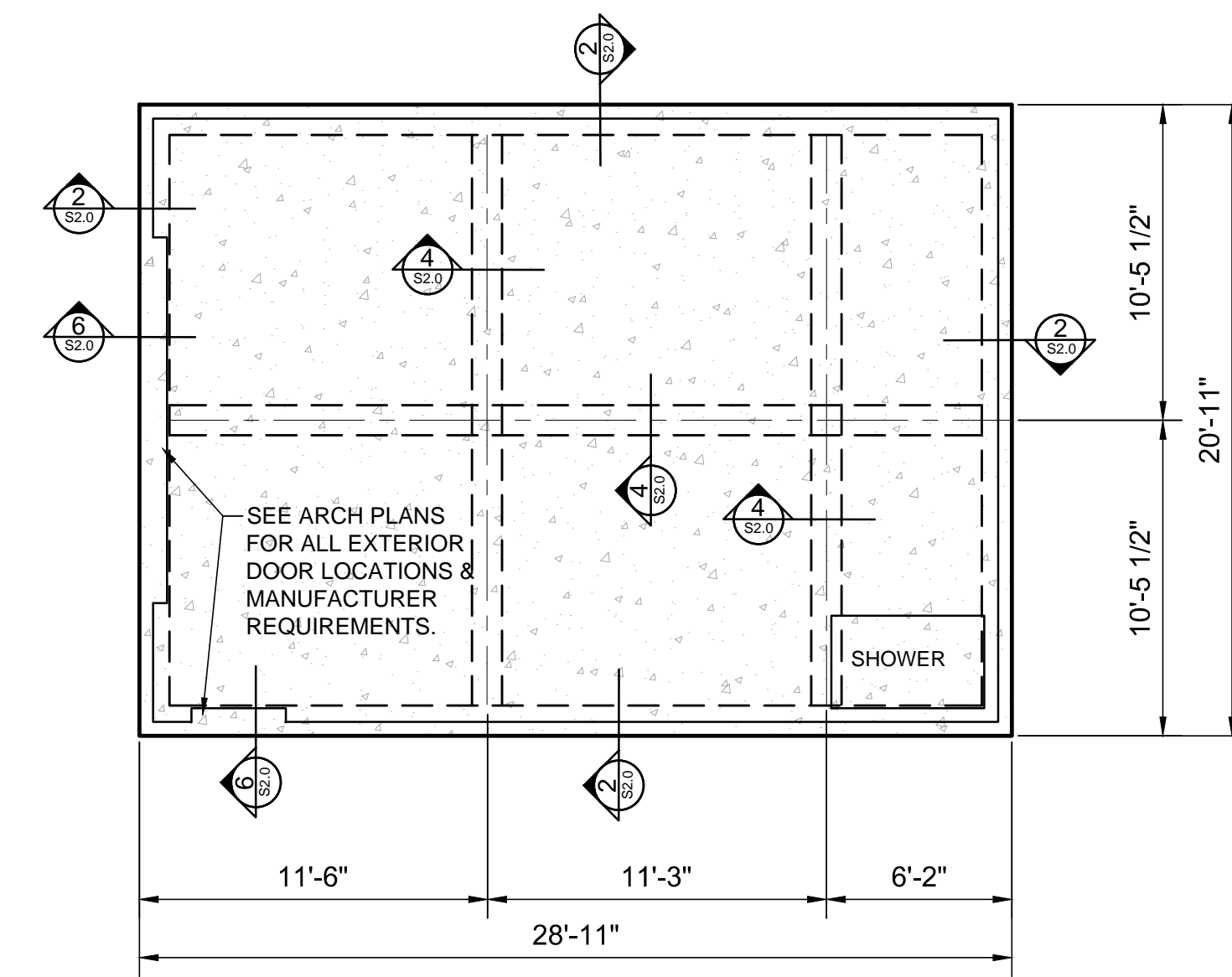

GAMEROOM FOUNDATION

SITE PREPARATION

1. REMOVE ALL TREES, STUMPS, ROOTS, ROOT BALLS, BRUSH, VEGETATION AND OTHER DEBRIS. TOPSOIL SHALL BE STRIPPED TO A DEPTH OF 4 TO 6 INCHES.
2. FOLLOWING THE NECESSARY SITE CLEARING AND STRIPPING THE BUILDING PAD SITE SHOULD BE PROOF ROLLED WITH A LOADED TANDEM AXLE TRUCK TO LOCATE ANY SOFT OR UNSTABLE AREAS. IF PRESENT, THESE SOFT OR LOOSE SOILS SHOULD BE REMOVED TO A STABLE SUBGRADE AND REPLACED WITH PROPERLY COMPACTED FILL MATERIAL. FOLLOWING PROOF ROLLING, THE SUBGRADE SHOULD BE SCARIFIED, MOISTURE CONDITIONED TO ABOVE OPTIMUM CONTENT, AND RECOMPACTED TO BETWEEN 95 AND 100 PERCENT STANDARD PROCTOR ASTM D 698.
3. THE BUILDING PAD SHOULD THEN BE BROUGHT TO ELEVATION USING SELECT FILL FREE OF ORGANICS AND OTHER DELETERIOUS MATERIALS WITH A MAXIMUM LIQUID LIMIT OF 30, A PLASTICITY INDEX BETWEEN 5 AND 12, AND HAVE A MAXIMUM PARTICLE SIZE OF 2 INCHES. THE SELECT FILL SHOULD ALSO MEET THE USCS CLASSIFICATION OF SC, GC OR CL. THE SELECT FILL SHOULD BE COMPACTED TO A MINIMUM OF 95 PERCENT STANDARD PROCTOR ASTM D 698 AT OR ABOVE OPTIMUM MOISTURE CONTENT. COMPACTED LIFT THICKNESS SHOULD NOT EXCEED 6 INCHES. WHERE CRUSHED LIMESTONE BASE IS USED FOR SELECT FILL THE BASE MATERIAL SHALL BE PLACED AT + OR - 2 PERCENT OF OPTIMUM MOISTURE.
4. IF SITE LEVELING IS REQUIRED THE EXISTING SOILS SHOULD NOT BE USED TO LEVEL THE SITE. ANY REQUIRED SITE LEVELING SHOULD BE COMPLETED WITH SELECT FILL.

REV	DATE	BY	DESCRIPTION
0	5/19/2022	CDR	RELEASED FOR CONSTRUCTION

DESIGNED	CDR	BFT	CDR	CDR	DATE
					5/2022



05/19/2022

Rosenbaum Engineering, PLLC
 325.669.2915
 2326 Wyncham Ct.
 Abilene, Texas 79606
 Clint Rosenbaum, P.E. | clint@rosenbaumeng.com

**Foundation Plan
 Boecker House
 Hidden Shores
 Cisco, Texas**

SHEET NO.

S1.0

1 OF 2